

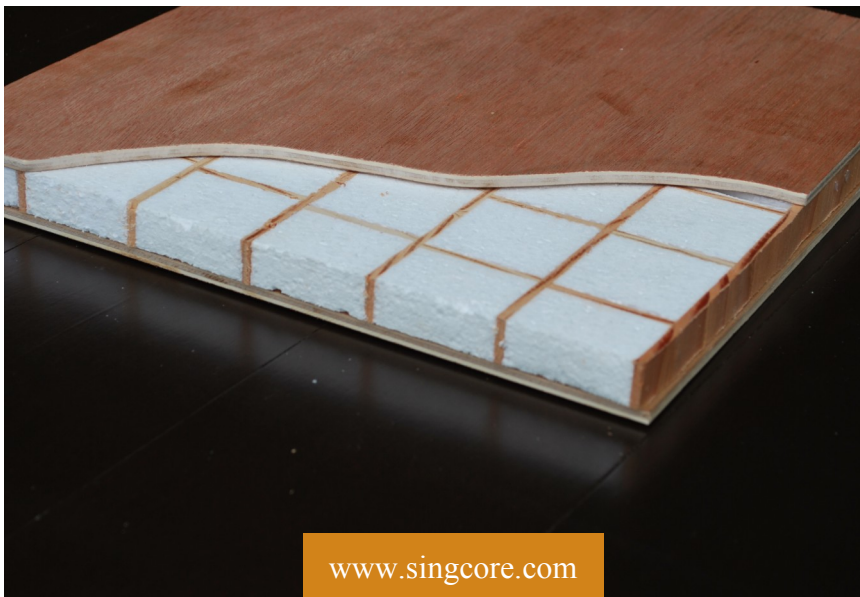

*A Better Choice
A Better Value
A Better Door*



True Flat
Lightweight
Strong
Eco-Friendly



Sing Honeycomb Advantages and Applications

Sing Honeycomb Advantages

True Flat

- Guaranteed flatness
- Won't sag over time
- The best structural guarantee in the industry

Lightweight

- 20% the weight of solid wood
- Average Weight: 1/2 Lbs. to 2 Lbs. per sq. ft.
- Foam core with torsion box structural implant

Insulated

- R-Value up to 6.5
- Sound Deadening Qualities

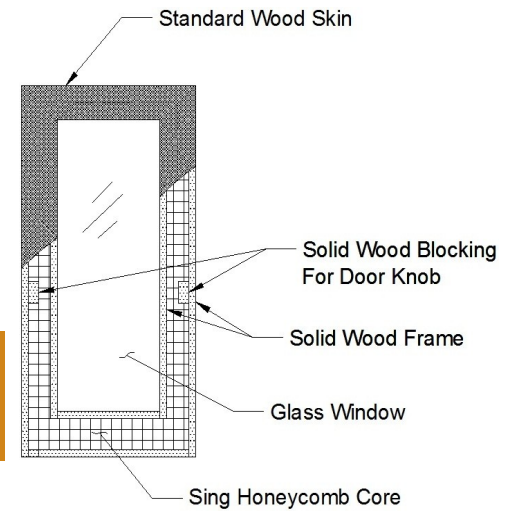
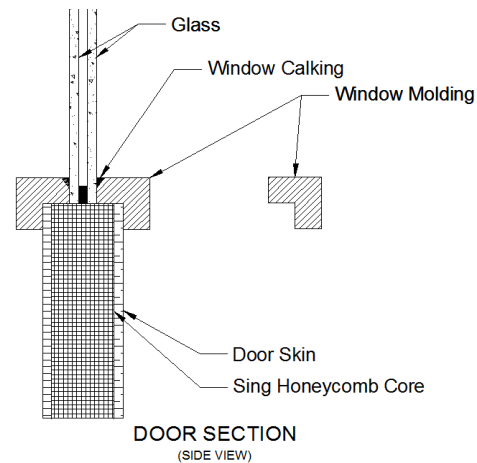

Strong

- Sustains up to 660 psi
- Torsion Box grid
- Vertically aligned veneer

Environmentally Friendly

- Recycled foam
- Renewable veneer
- Saves heating energy
- Energy efficient production

Fire-Resistant: Level 2

- Fire resistant skin available for code requirements in use with doors, walls, and floors

The standard 1 1/2" solid wood edging is adequate for door hinges but add solid wood blocking to your door core for added hardware or door knob needs.

Order the typical flat panel door or add trim to the panel to achieve the raised panel look.

About Sing Core

SINGCORE-The new generation of door making is an alternative to the old stile and rail door which has dominated the market for the last 100 years.

The new technology developed and patented by inventor Peter Sing makes doors stronger, more lightweight, saves more energy and is more dimensional stable than any stile and rail door. Best of all it is more affordable due to the reduction in labor used to produce Sing Panels and that savings is passed down to you and your customers. The entire glass cutout of the door is cut out of our solid Sing panel to create a seamless torsion box frame to replace the conventional stile and rail door, which is typically held together by dowels. The new Sing torsion box door frame is labor saving, earth friendly, the best of all it makes for a long lasting door. Our door cores fill a need in the sliding glass door niche because our cores are not only lighter than standard solid wood, fiberglass and composite door cores but our cores are stronger providing a longer lasting door core with a structural guarantee of 10 years which is about 9 years longer than the standard guarantee out there.

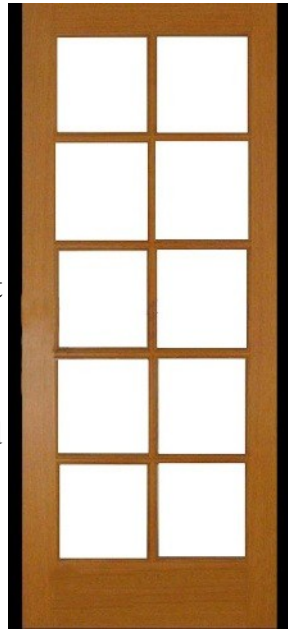

Get custom doors without the custom pricing!

Sing Honeycomb Panels are available at a fraction of the price of conventional sliding door panels, and require half the work. Sing Door Panels are insulated, lightweight, strong and more dimensionally stable than solid wood panels!

Choose Sing for all your Door Panels! When using Sing Panels, you design your own door by adding the trim, paint, and hardware. Sing

Door Panels are great for millwork shops and door builders. Special pricing is available to distributors and retailers.



Pricing

We specialize in custom orders, and have the ability to produce door cores of variable thickness, size and quantities.

To get started, call us at (360) 495-3577 or e-mail us at info@singhome.com for your free quote.



Visit our website to learn more about our:

- Technical Information
- Weight Calculator of Sing Door Panels
- How to Order
- Our Product Warranty
- Gallery of Sing Honeycomb Products

Contact Us

Sing Homes Inc.

Patented Sing Honeycomb Products
P.O. Box 1691
McCleary, WA 98557

Office: [360-495-3577](tel:360-495-3577)

Fax: [360-495-4585](tel:360-495-4585)

E-mail: info@singhome.com

Monday – Friday
8:30 AM - 4:30 PM PST

www.singcore.com

SINGCORE

engineered, patented + made in the usa.